

/ THE CHALLENGE OF THE PROJECT

ALTA
CONTRACT PROJECT



A N O T H E R V I E W

An aerial, high-angle photograph of Venice, Italy, featuring St. Mark's Basilica (Basilica di San Marco) and the Grand Canal. The image is overlaid with a semi-transparent dark blue filter. The text "WHY ALTA" is centered in a white, serif font.

WHY ALTA

WHY ALTA

RESPECT OF PEOPLE

We Value people through Valuable people. Appreciation and respect are essential in building Value relationships among individuals: in Alta, we want all the people of our world, Clients, Suppliers, Collaborators, Partners and the community in which we operate, to be integral parts of our project and we all constantly strive to promote principles of ethics, equality and diversity, trust and reliability in all that we do.

SUSTAINABILITY

We are aware of the responsibility we all bare for the future of our planet. Based on this principle, it is our purpose to improve the environment in which people live, respectfully preserving the external environment we will have to pass on to future generations. Therefore we commit to enforce a policy of social awareness and enhancement of the company processes in terms of impact and eco-sustainability, also through a conscious and efficient use of resources, which are limited, and in order to manufacture respectful products.

CORPORATE SOCIAL RESPONSIBILITY

Attention not only to the environment, but also to people. Doing business means valuing human resources, contributing to the development of expertise, actively participating in the local community where the company is operating and promoting constant innovation and growth aimed at a sustainable development.

ESSENTIALITY

A minimal and essential design, inspired by aesthetic criteria, that give life to beautiful, important and functional spaces, but also elegant and discrete, based on the principles of ergonomics: this is the philosophy inspiring our creations.

SPACES BECOMING PROJECTS

Space is an inspiration, space becomes the incentive to thinking, a container to be filled with contents and functions for the benefit of people who will enjoy them. It is from this unique and unrepeatable combination of desires and needs, environment, time and materials that the project idea is born and takes shape in a specific space.



PROJECTS TAKING SHAPE



The art of know-how and its main actors, the people: the true secret ingredient. They are not only the custodians of an artisanal expertise and of a distinctive know-how, but the actual protagonists of the company, in a cooperative and collaborative environment and in symbiosis with the outside stakeholders of the business.



ALTA

A L T A C O M M I T M E N T

Commitment and transparency

Innovation in project management
is named Alta Commitment.

We guarantee full visibility to our clients
with an end to end process
of the project, divided into ten phases and
codified by the Alta certified protocol.



COMMITMENT AND TRANSPARENCY

Our innovative approach to project management is called the Alta Commitment: we guarantee our clients total visibility from beginning to end of their project, with a ten-stage process which is formalised in the Alta protocol.

EXCELLENCE AS THE RESULT OF EXPERIENCE

Our obsession with constant improvement and excellent performance led us to set down our ACA protocol, based on 10 distinct steps that make up the stages of the project. The result is guaranteed management of our in-house processes, which are subjected to rigorous checks in order to certify their quality.

01 /

Analysis of the project and preliminary proposal

03 /

Detailed quote and approval of the proposal

05 /

Project calendar

07 /

Production and progress of the work

09 /

Delivery and installation

02 /

Definition of the surroundings

04 /

Preparation of technical documentation

06 /

Technical specifications and installation documentation

08 /

Logistics of the project

10 /

Warranty and continuing support

ALTA COMMITMENT

CASE STUDY

“THE TWENTY 1”



Located in the elegant neighborhood of Chelsea, in Manhattan, “The Twenty 1” is a new luxury residential project, which involved carrying out a large renovation through the redesign and transformation of an existing four-storey commercial building, into a structure including six full-floor units and two duplex penthouses.



01/

ANALYSIS OF THE PROJECT AND PRELIMINARY PROPOSAL

In the preliminary stage, initial meetings with the general contractor and the architect's studio are essential in order to understand the client's needs and preferences.

Alta offers the possibility of a 100% bespoke service, including the production and supply of one-off items which add extra value to any project.



APARTMENT

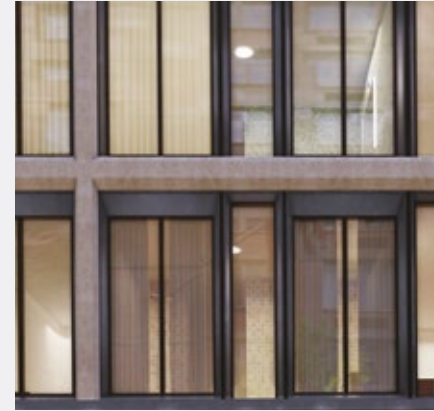

ARCHITECTURE DETAIL



PROJECT DETAILS

ARCHITECTURE
FIRM:
GRADE
NEW YORK

"In order to increase the sale value of the single units, it was important that ALTA was able to insure a 100% Custom Made service, creating unique, modern and elegant pieces, which would increasingly value the structure".

"We asked ALTA to provide all the documents relevant to the company (employee's insurance, compliance with US applicable laws and regulations) in order to be certain that it was suitable as a contractor for this project".

GENERAL
CONTRACTOR:



02/

DEFINITION OF THE SURROUNDINGS

Viewing the rendered images together allows us to gain an in-depth understanding of the prevailing style of the space; at Alta we use a mood board to display different combinations of colours and materials, which is then used to develop a solution.



RENDER KITCHEN



RENDER LIVING

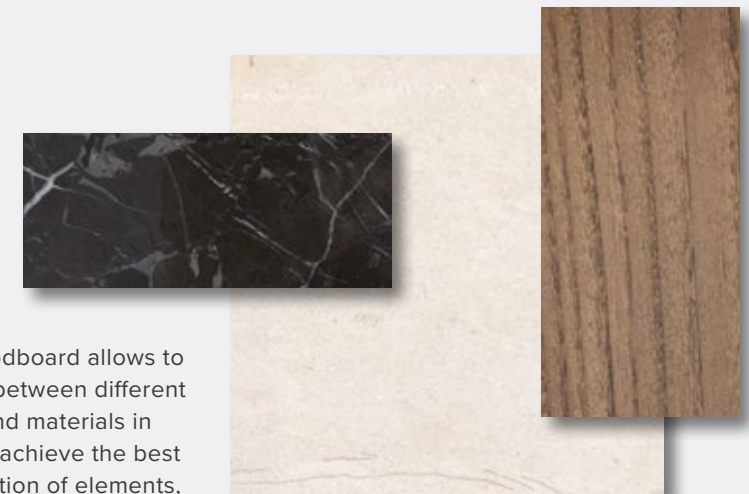

MOODBOARD

The Moodboard allows to choose between different colors and materials in order to achieve the best combination of elements, precisely reflecting the project and satisfying the clients expectations.

03/

DETAILED QUOTE AND APPROVAL OF THE PROPOSAL

On the basis of the client's requirements, Alta provides a detailed and clear costing for the execution of the project, expanding all the expenses and relevant information for every component and service.

Alta's exceptional value comes from our ability to offer clients alternative materials and components with a range of options in terms of quality and price.



QUOTATION



CUSTOM MADE SOLID
WOOD DOORS

TAJ MAHAL
QUARTZITE

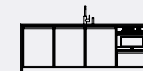
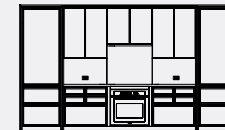

Quotation for	1 Qty	US \$
Quotation for	2 to 6 Qty	US \$
Quotation for	7 Qty	US \$

Quotation for	1 Qty	US \$
Quotation for	2 to 6 Qty	US \$
Quotation for	7 Qty	US \$

ALTA's Added Value is its ability to suggest alternative solutions to the Client in terms of both materials and components, with a different positioning in terms of levels of quality and quotations.

04/

PREPARATION OF TECHNICAL DOCUMENTATION

Our technical office drafts the technical documentation, including detailed drawings of every detail in every room, the technical construction specifications, known as Civil Work, and plans for the coordination of water and electricity systems, with a particular focus on the US regulations for people with disabilities (ADA). The technical drawings include precise indications of materials to be used and the sizes and specifications of all components.

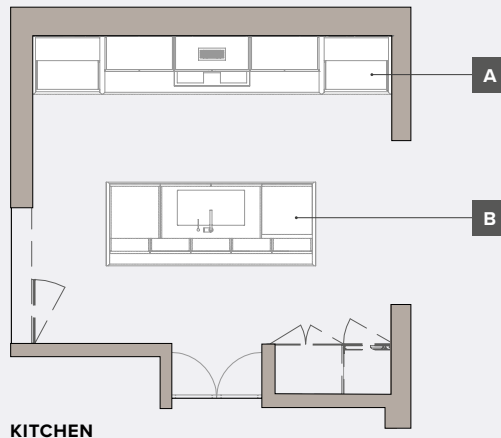

A Kitchen elevations

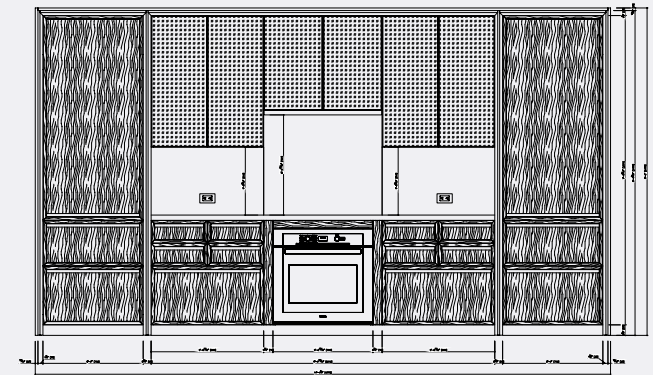
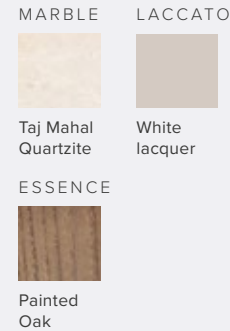

B Island unit elevation – washing line side

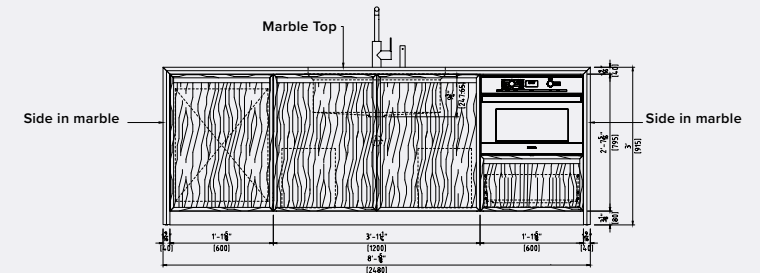
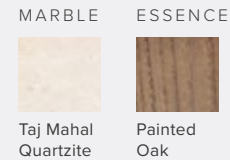

B Island unit elevation - back

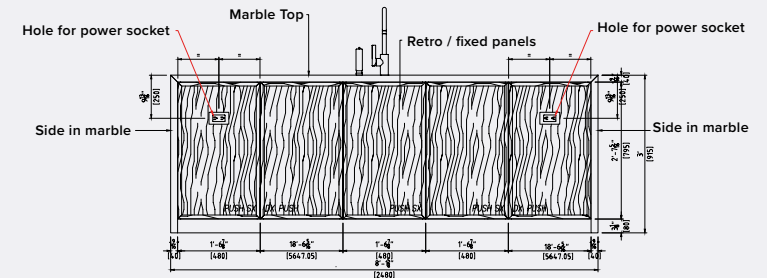
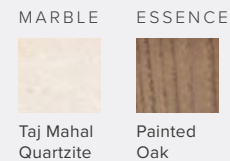

05 /

PROJECT CALENDAR

In our offices, the various stages of the project are planned and allocated to the different departments involved in the process, while remaining in constant touch with the architect's studio and the general contractor for the execution of the final project.



Design execution and control of specifics:

The technical office is responsible for the implementation of the design solutions, in compliance with the specific indications and technical requirements of the customer and in line with the regulations in force at local level.

Continuous relationship with the architecture firm:

The company is in constant contact and maintains an ongoing discussion with the clients requesting the project, always ready to intervene in case of possible variations or changes during the works.

Briefing and internal discussion:

An essential component of ALTA's internal production process is the continuous cooperation and discussion through company briefings among departments.

Time and costs monitoring:

A precise planning of the operations requires the management, control over and compliance with the timeline, as well as the monitoring of costs and satisfaction of the requested quality specifics.



06/

TECHNICAL SPECIFICATIONS AND INSTALLATION DOCUMENTATION

Following surveys carried out on the site, the Alta Design Department provides the architect's studio with detailed graphics, installation drawings, product specifications and samples of finishes for the final composition, for approval by the client.

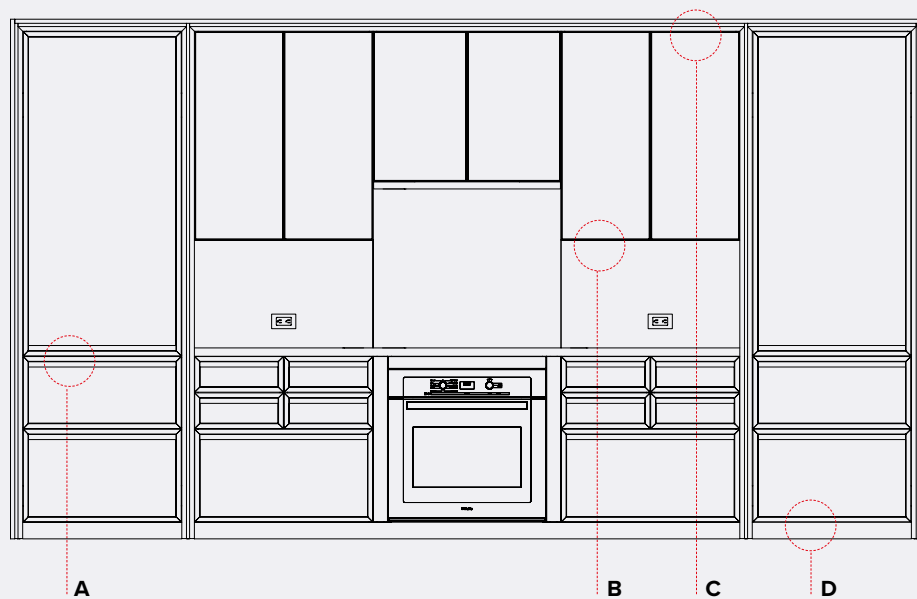

Detail A

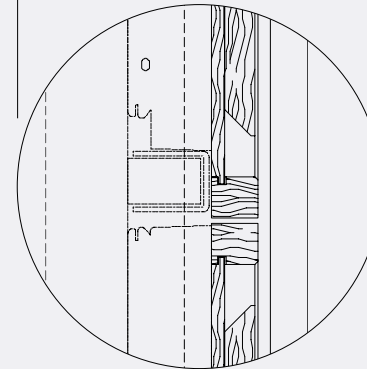

Detail B

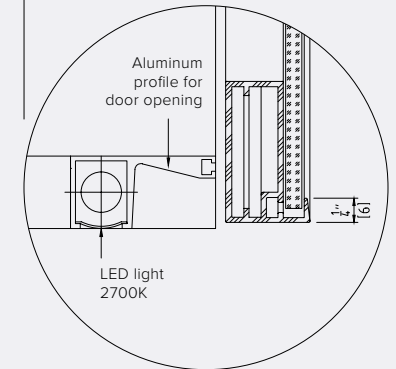

Detail C

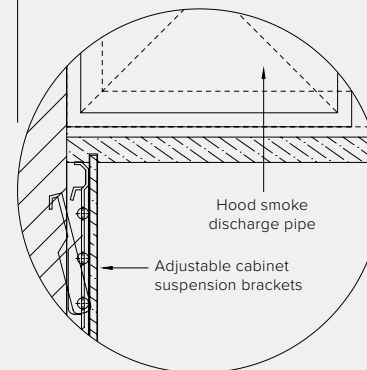

Detail D

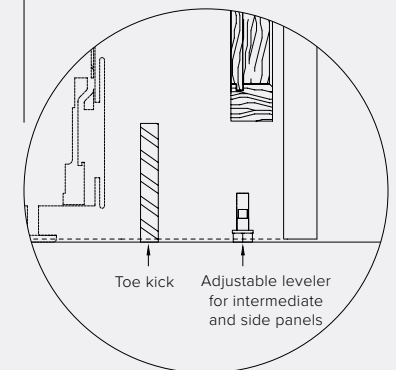

Wide variety of choices among substantially unlimited options in combination with our offer of a custom-made service allow complete flexibility, insuring the highest degree of satisfaction of our client's expectations.

07/

PRODUCTION AND PROGRESS OF THE WORK

Alta's competitive advantage is the result of a combination of artisan skill and technical innovation. Our services stand out for their quest for quality and consistency, meticulous selection of exclusively Italian raw materials, and environmental and social sustainability.



PRODUCTION

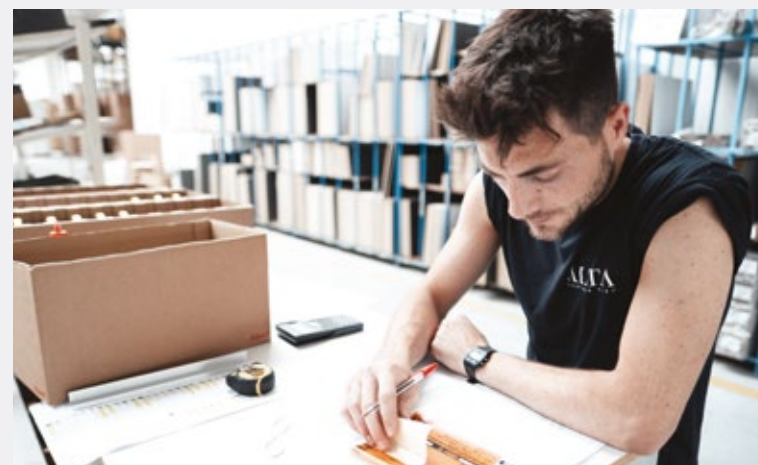

Adhering to our environmental and social sustainability policy, we commit to use, during the coating phase, water-based coatings, which safeguard human health, are completely odorless and devoid of toxicity.

08/

LOGISTICS OF THE PROJECT

Management of work flows is essential to ensure the timing of the project is adhered to.

Alta scrupulously monitors movements of materials at every stage of the production process, from supply of materials to final delivery, in which external logistics management is crucial for handling complex projects at national level, and even more so internationally.



LOGISTIC

A packaging, which preserves the integrity of the components, suitable for any type of carrier, including ships and planes, is designed and created on the basis of the characteristics of materials and processing and on the destination country.



The company constantly invests in innovation technology, urging to adopt instruments and solutions in accordance with the principles of the 4.0 industry.

09/

DELIVERY AND INSTALLATION



3D RENDER

With a particular focus on details and harmonious cohesion between different rooms, Alta undertakes to fulfil the stated requirements and the promises made: the real-life images of finished projects are a faithful reflection of the initial renders.



REAL PHOTO



10/

WARRANTY AND CONTINUING SUPPORT

Our commitment to our clients continues over time. Even after the sale and delivery of the finished product, Alta guarantees its quality with a meticulous after-sales service.

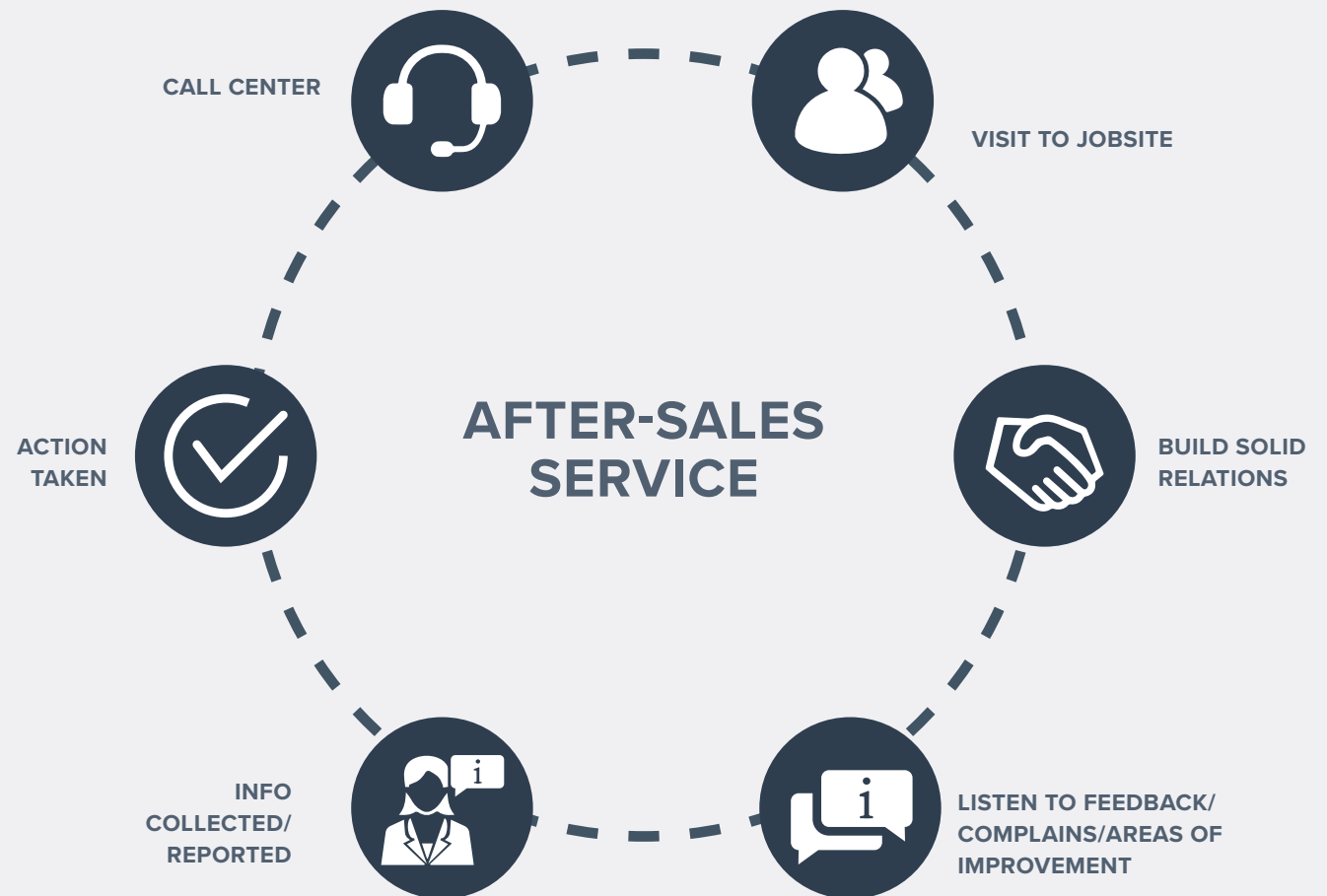

CERTIFICATIONS

Guarantee on materials

Quality, as the result of a long research and of a very rigorous selection process, is the distinguishing characteristic of the material utilized in our manufacturing unit.

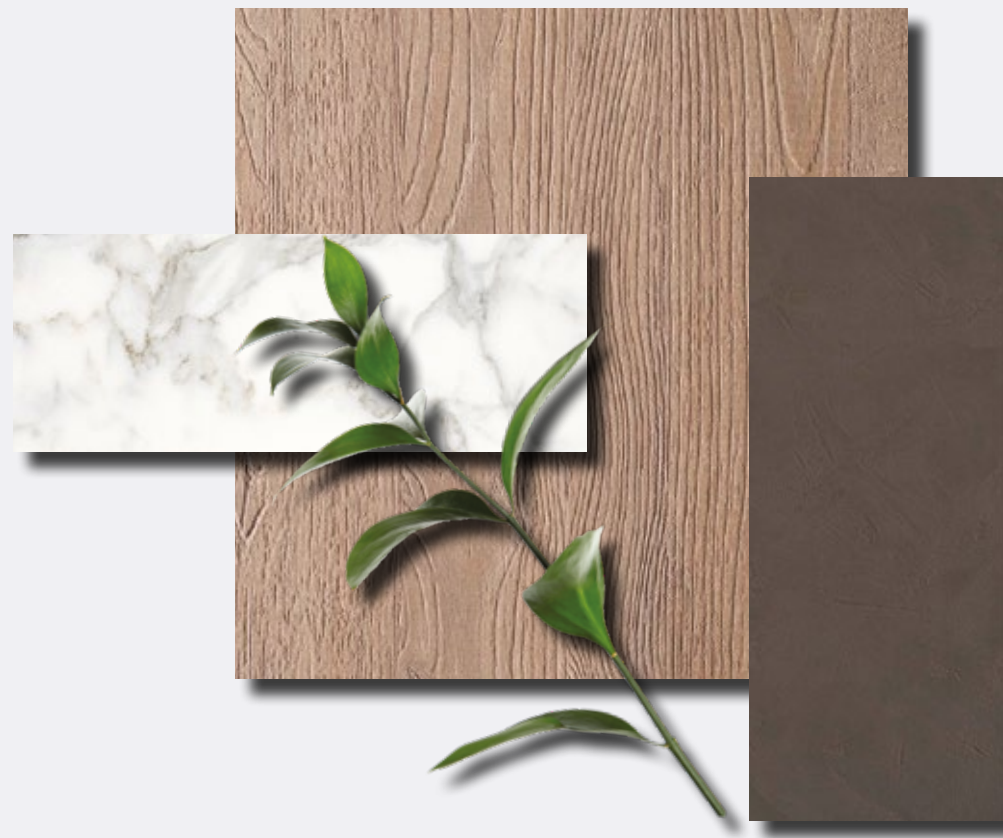

ALTA makes use, for all its productions, of panels compliant with the emission limitations provided by the CARB ATCM Phase II or by the U.S. EPA TSCA Title VI (Toxic Substances Control Act) and certified by a TPC (Third Party Certifier) recognized by CARB and EPA.



Forest Stewardship Council

The FSC®: the certified wood.
Since 2010 Alta resorts only to FSC® certified suppliers, guaranteeing that the supplied wood comes from forests that are managed in a responsible manner.
Search for FSC certified products.

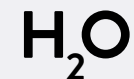

For its panels, Alta utilizes only coatings with water-based solvents: it is, a matter of fact, possible to reduce by 95% emissions of VOC (Volatile Organic Compounds) in the environment as compared to the use of solvent-based coatings. Furthermore, it must also be recalled that the water-based coatings are completely odorless, non-flammable and have a particularly low level of toxicity.



WHERE ALTA

References all over the world

ALTA operates and implements its creations all over the world:

- America
- Europe
- Africa
- Asia
- Oceania

International architecture firms

We are honored of having implemented projects of and having cooperated with primary and important international architecture firms, amongst which: Think Architecture, AA Studio, ODA Architect, Workshop DA, Narofsky Architecture, Paz Arquitectura.

ALTA

Multi-unit

The Oosten, NY
Vitre Condominium, NY
287 East Houston, NY
416-420 Kent Av Brooklyn, NY
357 West 17TH Street

Private Mansion

Townhouse, NY
Sands Point Mansion, NY
Murray Hill, NY
Corallo House, Guatemala City
Dunbar Residence, Canada



THE OOSTEN

LOCATION:
BROOKLYN, 421 KENT AVENUE,
NY 11249

ARCHITECT(S):
THINK ARCHITECTURE

INTERIOR DESIGNER(S):
PIET BOON

GENERAL CONTRACTOR:
WONDER WORKS

FURNISHING SUPPLIED
KITCHENS, PANTRIES, WARDROBES,
BATHROOMS, MEDICINE CABINETS

UNIT:
215

YEAR:
2017

Located on the lively shore of South Williamsburg, a cool neighborhood undergoing an intense growth and offering uncountable services, The Oosten brought the concept of luxury living in New York to a completely new level. A rare example of development designed by the famous Dutch architect Piet Boon, who conferred to each residence a modern touch, suitable for single individuals or families in search of the "Williamsburg lifestyle", a balance between simplicity and elegance.





VITRE CONDOMINIUM

LOCATION:
MANHATTAN, 302 EAST 96TH STREET,
NY 10128

ARCHITECT(S):
KARL FISHER

INTERIOR DESIGNER(S):
ELIANART

GENERAL CONTRACTOR:
WONDER WORKS

FURNISHING SUPPLIED:
KITCHENS, PANTRIES, WARDROBES

UNIT:
48

YEAR:
2019

A new approach to life in the Upper East Side. Vitre is a unique condominium, different from any other in the area. Modern and refined, it combines a sophisticated European-inspired design, built using material of extremely high quality, all wrapped in a splendid glass facade. An elegant and welcoming window in one of Manhattan's most desirable neighborhoods, the building is located in setting dense with tradition, only a few seconds from the new Second Avenue underground station, in a location that grants access to the infinite possibilities of the entire city.





287 EAST HOUSTON

LOCATION:
NEW YORK, 287 EAST HOUSTON
STREET, NY 10002

ARCHITECT(S):
AA STUDIO

INTERIOR DESIGNER(S):
AA STUDIO

GENERAL CONTRACTOR:
WONDER WORKS

FURNISHING SUPPLIED:
KITCHENS, PANTRIES, BATHROOMS,
MEDICINE CABINETS

UNIT:
27

YEAR:
2019

The 287 East Houston is the most successful new ground-up on Houston Street. An Italian-inspired presence echoes outside with the elegant facade made in blackened steel, black-textured bricks and large full-height glass panes.

This luxury structure, completed in 2018, is spread over 11 floors and houses 27 residences.

Our company, for this project, was entrusted with the supply and installation of the kitchens, pantries and bathroom furniture.





416-420 KENT AV BROOKLYN

LOCATION:
BROOKLYN, 416-420 KENT AVENUE,
NY 11249

ARCHITECT(S):
ODA ARCHITECT

INTERIOR DESIGNER(S):
ODA ARCHITECT

GENERAL CONTRACTOR:
ZDG CONSTRUCTION MANAGEMENT

FURNISHING SUPPLIED:
VANITIES AND MEDICINE CABINETS

UNIT
857

YEAR:
2019

420 Kent Avenue, an unprecedented life experience, directly on the East River, in Williamsburg, Brooklyn. Composed of three multidimensional glass towers designed by the multi award winner architecture firm ODA New York, 420 Kent will host: 875 residences, 20,000 square feet of restaurants and retail spaces, over 25,000 square feet of indoor facilities and more than 80,000 square feet of outdoor spaces, including a 400-foot landscaped riverside, located in the center of the South Williamsburg Waterfront, one of Brooklyn's best neighborhoods.





357 WEST 17TH STREET

LOCATION:
NEW YORK, 357 W 17TH ST,
NY 10011

ARCHITECT(S):
WORKSHOP DESIGN+ARCHITECTURE

INTERIOR DESIGNER(S):
ALENA DE PLOTI

GENERAL CONTRACTOR:
WONDER WORKS

FURNISHING SUPPLIED:
**KITCHENS, PANTRIES, CUSTOM MADE
BAR, MILLWORK AND WARDROBES**

YEAR:
2017

A modern design townhouse concrete made in one of the most exciting neighborhoods in Manhattan, represents the best solution to fully experience the vibrant West Chelsea. With 11,000 square feet of living space, 2,000 square feet of outdoor surface, the atmosphere is airy, unobstructed and incredibly fascinating. In this context, five bedrooms with private bathroom, 12 bathrooms, an immense professional kitchen, comparable to those of restaurants, and sumptuous interiors offer an exceptional backdrop to an extremely elegant life experience.





SANDS POINT MANSION

LOCATION:
SANDS POINT, NY 11050

ARCHITECT(S):
NAROFSKY ARCHITECTURE

INTERIOR DESIGNER(S):
ARCHIGEO4

GENERAL CONTRACTOR:
WONDER WORKS

FURNISHING SUPPLIED:
KITCHENS, PANTRIES, CUSTOM MADE
BAR, MILLWORK AND WARDROBES

YEAR:
2017

An exceptional villa plunged in the green surrounding of the Sands Point Golf Club, characterized by a unique design of shapes and water effects. The residence, designed in harmony with the surrounding landscape, stands out from the traditional residences in the neighborhood for its concrete panel, the mahogany cladding and green roofing system.





MURRAY HILL

LOCATION:
NEW YORK, PARK AVE, NY 10021

ARCHITECT(S):
JOHNATHAN HELD

INTERIOR DESIGNER(S):
ARCHIGEO4

DEVELOPER:
WONDER WORKS

FURNISHING SUPPLIED:
KITCHENS, PANTRIES, AND WARDROBES

YEAR:
2016

The Kitchen hosts two island units in white Carrara marble and fronts in white glossy lacquer; the tones of the marble stones, which contrast with the black inserts on the wall, constitute the distinctive trait of the entire apartment and contribute to enhance the brightness of the setting and convey a higher perception of wideness and vastness to the spaces. Located in the exclusive Park Ave, this renovation resulted in a unique living space, characterized by a contemporary style.





CORALLO HOUSE

LOCATION:
GUATEMALA CITY

ARCHITECT(S):
PAZ ARQUITECTURA

INTERIOR DESIGNER(S):
PAZ ARQUITECTURA

FURNISHING SUPPLIED:
KITCHEN, LAUNDRY AND PANTRIES

YEAR:
2011

Located in the midst of a dense hill forest in the Santa Rosalia area, in Guatemala City, Corallo House incorporates the existing forest in the landscape of the house. It combines the surrounding nature with the architectural project; the design process started with the objective of preserving the existing trees and conveying the sense of interaction between them and the living space. The main component is the exposed concrete, which shows the rustic texture of the wooden formwork, therefore fostering the interaction between the formal component and the forest's textures.





DUNBAR RESIDENCE

LOCATION:
VANCOUVER,
CANADA

ARCHITECT(S):
FRITS DE VRIES ARCHITECTS

INTERIOR DESIGNER(S):
ASSOCIATES LTD

FURNISHING SUPPLIED:
KITCHEN AND CLADDING, PANTRIES,
MAIN LIVING ROOM WALL AND TV
UNIT, WARDROBES, OFFICE, VANITIES.

YEAR:
2013

Dunbar 33 is a modern 257 square meter home built in 2013 in the Dunbar neighborhood, in Vancouver, an area characterized by quiet residential roads bordered by large ancient trees and quiet parks.

The house is designed around a space, divided into two and double height, facing the garden on the south side and offering an incredible mountain view on the north side. The center of the building is see-through on both sides, allowing light to enter all day long.

To recreate the harmonious effect with cedar wood, stucco and zinc that characterize the exterior of the house, Alta conceived the kitchen and the furniture combining walnut wood with white concrete finishes, thus creating an interesting and luminous contrast of colors and materials.





SHEERWATER RESIDENCE

LOCATION:
CANADA

INTERIOR DESIGNER(S):
MARIUS SCHEEPERS

FURNISHING SUPPLIED:
KITCHENS AND WARDROBES .

YEAR:
2021

A dream residence, with a spectacular panoramic view, overlooking the lake in the Okanagan Valley, Canada. In this unique and exclusive context, we took care of all the interior supplies.

The kitchens and living areas were made in elegant lacquers and with first choice veneers.

The wardrobes and cabins and other areas of the house were made to measure and with maximum customisation to meet the customer's expectations.

We also furnished the guest house with the same moods. A project of the highest level that projects the company into a new focus and a new philosophy in its approach to residential contract interiors.

Many thanks to senior interior designer Marius Scheepers for his vision of the project.



REFERENCE LIST

Completed projects

2010 – Tiffany Cañada, Guatemala City
2010 – District Condominium, New York - Fulton Street
2011 – Corallo House, Guatemala
2011 – Résidence Au coeur des ours, Les Deux Alpes, Francia
2013 – Dunbar 33 Dillon House, Vancouver, Canada
2014 – Tiffany 5ta Avenida, Guatemala City
2015 – 338 Berry, Brooklyn
2015 – 540 West, New York - 540 - 545 West 49th Street
2015 – Spectra, Hartford (Connecticut)
2015 – The Oosten, Brooklyn - 421 Kent Avenue
2015 – 1868 Van Ness Ave, San Francisco
2016 – Murray Hill, New York - Park Ave
2016 – 372, New York - 5th Avenue
2017 – Residence Alexandra, London (UK)
2017 – Townhouse, New York, 357 W 17th St
2017 – Sands Point Mansion, Sands Point
2018 – The Parioli, New York - 114 Mulberry Street
2018 – 436 - 442 East 13th Street, New York
2018 – Vitre Condominium, Manhattan - 302 East 96th Street
2018 – 1830 E Mercer St, Seattle
2019 – 420 Kent Avenue, Brooklyn - 416-420 Kent Avenue
2019 – 287/LES, New York - 287 East Houston Street
2018 – The TwentyOne Chelsea (NY)
2019 – The Smile Harlem (NY)
2020 – Tiffany Novena Guatemala City
2020 – Broad Street Philadelphia
2020 – Walnut street Philadelphia
2020 – 298 e 2nd street Manhattan (NY)
2021 – Broadmead Street London
2021 – 30 Kent Street Brooklyn
2021 – 1834 3d ave Manhattan
2021 – Girrard Ave Philadelphia
2021 – 14 Clinton Manhattan
2021 – 48 Allen Street Manhattan
2021 – 2125 1st Ave Seattle
2021 – 118 e 1st street Manhattan (NY)
2021 – 75 1st Ave Manhattan (NY)



2019
101 Pearl Street, Hartford
(Connecticut)



2019
Residence Nivaria,
Zeebrugge (Belgio)



2020
Houston House, New York,
298 East 2nd Street
(NY 10009)



2020
30 Kent Street, Brooklyn
(NY 11222)



2020
Tiffany Novena,
Guatemala City



2020
126 Gotham Plaza, Harlem
(NY 10035)

STRUCTURAL CHARACTERISTICS

ALTA

CONTRACT PROJECT

/

STRUCTURAL CHARACTERISTICS

CARCASSES

All the base, wall and tall units are made of load-bearing structures consisting in 18-mm thick, class CARB 2 - TSCA title VI compliant, wood particleboard with very low formaldehyde emissions, faced with abrasion-resistant melamine that is easy to clean. All base and tall units have back panels with 62-mm recesses to accommodate pipe and cable runs and for ventilation purposes, etc. There is a 16-mm service gap for wall units.



White melamine



Gray melamine

/

STRUCTURAL CHARACTERISTICS

EDGES SHELVES

The ABS edges, applied with polyurethane glues, are very important because they add impact, humidity and steam resistance to the structural elements. They are 15/10 thick for the White carcass and 10/10 thick for the Gray one.

The interior shelves are made of 18-mm thick, class CARB 2 wood particleboard panels. They are provided with shelf supports with pins that ensure stability and resistance to loads and prevent the shelves from moving out of place and tilting.



On the front edge it is possible to add, on request, a stainless still profile “U” shaped thickness 25 mm that improves both resistance and the beauty of the shelves.



The glass shelves are also fixed to the unit by means of shelf supports provided with lock pins that keep the shelf secured to the carcass (as prescribed by safety regulations).

/

STRUCTURAL CHARACTERISTICS

THE SINK BASE UNITS / DISH-DRAINER UNITS

The sink base units are supplied with an aluminium bottom panel lining that gives good protection from water leaks, liquid detergents, soaps and the like. By request the internal sides are also available.

Dish-drainer units can be equipped with aluminium coating on the back and sides, having an effective protection against water and vapor.



/

STRUCTURAL CHARACTERISTICS

HINGES / STRENGTHENING BARS

All wall units and other units with doors are supplied with soft-close, quick-fit hinges with a 110° opening radius that can be adjusted in three directions. The metal hinges are galvanized to make them become fully resistant to steam and to chemical substances. The corner units and the tall units provided with interior drawers fit hinges with a 155° opening radius for better access to the interior compartments and to ease drawer extraction.

The base unit carcasses are provided with aluminium strengthening bars. In addition to being very effective and attractive, these bars make the carcass extremely sturdy and stable.



/

STRUCTURAL CHARACTERISTICS

FIXINGS / BACKS

Wall units are provided with fixings that can be adjusted horizontally and vertically from the inside and that resist to heavy loads (up to 100 kg) including the weight of the unit itself.

The interior fixing is also provided for 34-cm deep wall-hung base and tall units.

All the furniture (base units, wall units, tall units) are equipped with reinforced backs.

The thickness is 5 mm: this give guarantee of big tightness and stability of the structure.

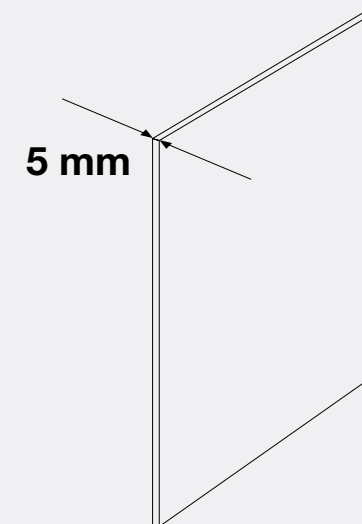

/

HIGH-QUALITY ACCESSORIES

LEGRABOX / PUSH-TO-OPEN

DRAWERS AND LARGE DRAWERS

To satisfy any design and originality requirement in the best possible way, Alta srl also makes the new, elegant Blum box system called LEGRABOX available to its customers which stands out for its linear, clean-cut design and very smooth movements.

PUSH-TO-OPEN DRAWER MECHANISM

The new furnishing trends that prefer increasingly more linear and clean-cut lines call for opening systems without handles. On request, our kitchens can be fitted with push-to-open drawers and large drawers. This consists in a mechanism located behind the drawer runners that allows the drawers to be opened with a touch of the fingers and without handles.



/

STRUCTURAL CHARACTERISTICS

FEET / PLINTHS

The plastic feet are fitted with a plate that holds up the weight of the side panel so that it is not supported by the cabinet's bottom panel. Consequently, the base unit becomes very stable and can support a heavier load. The feet are available in 4 heights: 8 - 10 - 12 - 15 cm.

All the plinths are constructed from materials that resist to water and humidity so that the kitchen can be cleaned using traditional cleaning methods (water and liquid detergents, etc.).

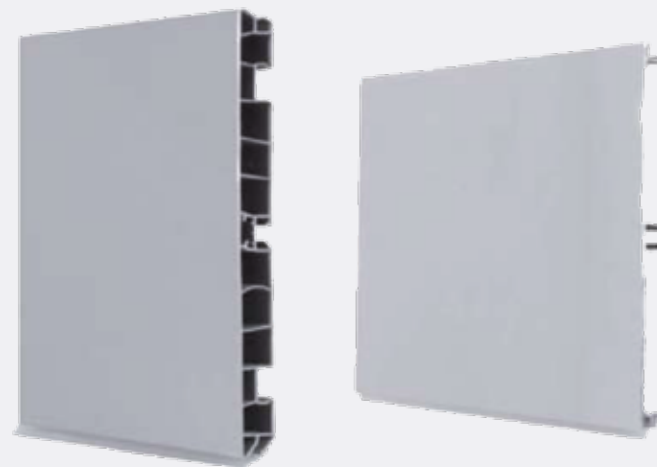

/

HIGH-QUALITY ACCESSORIES

LEGRABOX / PUSH-TO-OPEN / SERVO-DRIVE

DRAWERS AND LARGE DRAWERS

To satisfy any design and originality requirement in the best possible way, Alta srl also makes the new, elegant Blum box system called LEGRABOX available to its customers which stands out for its linear, clean-cut design and very smooth movements.

PUSH-TO-OPEN DRAWER MECHANISM

The new furnishing trends that prefer increasingly more linear and clean-cut lines call for opening systems without handles. On request, our kitchens can be fitted with push-to-open drawers and large drawers. This consists in a mechanism located behind the drawer runners that allows the drawers to be opened with a touch of the fingers and without handles.

“SERVO-DRIVE” DRAWER AND WALL UNIT OPENING MECHANISM

For all those who love innovation and technology in the kitchen, Alta srl offers Servo-drive, an electric drawer and large drawer opening system. To operate the electric opening mechanism, lightly press on any part of the drawer front. The drawer will then slide back silently and effortlessly, thanks to the BLUMOTION system.



/

HIGH-QUALITY ACCESSORIES

INTERIOR LIGHTING

INTERIOR LIGHTING FOR LARGE DRAWERS

All base units with doors and drawers can be fitted with interior lighting consisting in high-efficiency aluminium LED lights.

Various types of midway lighting are available such as luminous LED inserts in wall unit bottom panels, exterior LED light strips in aluminium and exterior lights. Even the grip recesses used to open wall units without handles are available with an optional built-in lighting system. We recommend this type of lighting because it is an excellent way to illuminate kitchen worktops while adding extra aesthetic appeal to the kitchen.

LED panel for cabinet and cupboard back panel installation with no-dots effect; in 12/24VDC it's available with warm or natural white and Emotion Dual Color 3000-4000K light temperature. Very limited thickness of only 13 mm.

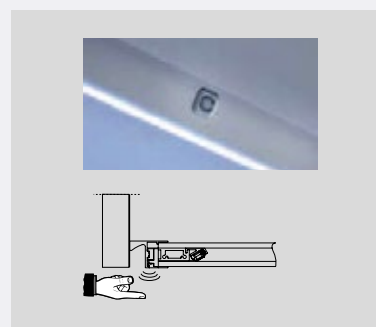



HIGH-QUALITY ACCESSORIES

BLUM AVENTOS

BLUM AVENTOS HF FOR BI-FOLD LIFT DOORS

AVENTOS HF is ideal for higher wall units, because the handle is easily reached in any position. Thanks to the front divided into 2 parts, there is a minimum upper space occupied with AVENTOS HF. AVENTOS HF permits also to put fronts of different heights.

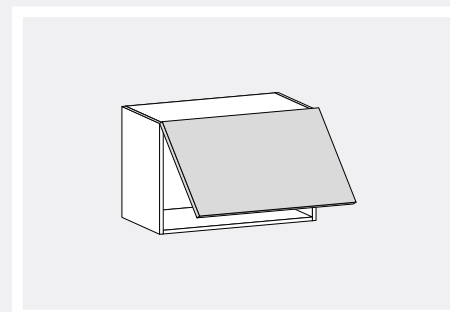
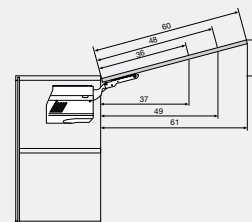
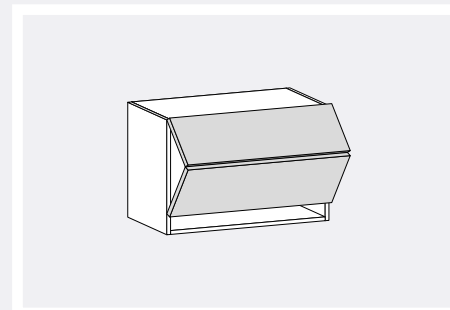
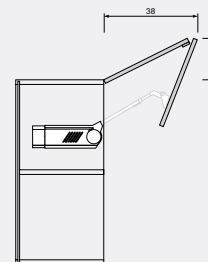

BLUM AVENTOS HK FOR LIFT-UP DOORS

AVENTOS HK is the ideal solution for lower wall units, as well as for use in tall units and above the fridge. Thanks to the movement of the flap door, there is a minimum upper space occupied.

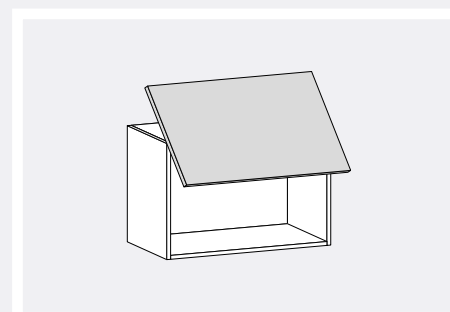
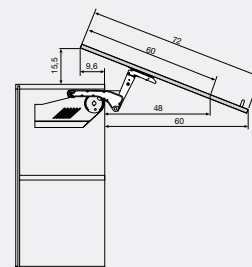

BLUM AVENTOS HS FOR LIFT-UP AND OVER DOORS (OBLIQUE DOOR)

AVENTOS HS is ideal for big one-piece fronts. Thanks to the folding movement, there is a minimum upper space occupied.

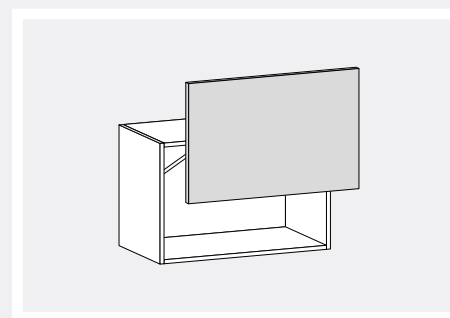
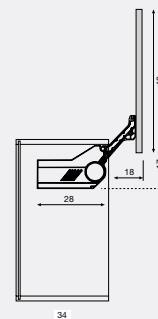

BLUM AVENTOS HL FOR LIFT-UP AND OVER DOORS (VERTICAL DOOR)

AVENTOS HL is ideal for big one-piece fronts. Thanks to the folding movement, there is a minimum upper space occupied.

/

S22 FRONTS

The 22 mm door thickness: the feature that sets us apart. Our Sistema 22.2 offers various possibilities for customisation of doors and fronts, paying particular attention to ergonomics and design.

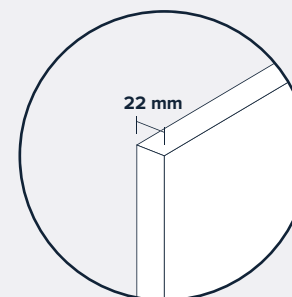
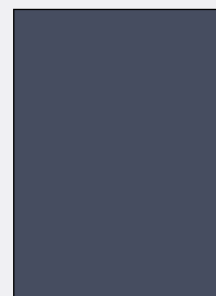

S22 SPAZIO



S22 METAL

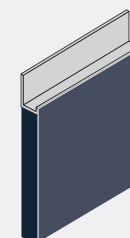

S22 BRERA

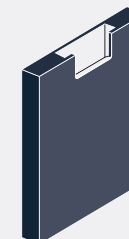

S22 TRATTO



OPENING METHODS



	PUSH PULL	FLAT GRIP GROOVE	CONCAVE GRIP-GROOVE	HANDLE
FRONTS				
S22 SPAZIO	●		●	●
S22 QUARANTA5		●		
S22 TRATTO		●	●	
S22 LINEA		●	●	
S22 DIAGONAL		●	●	

S22 LINEA



S22 DIAGONAL



S22 QUARANTA5



/

S22 FRONTS

TELAIA SPAZIO

The 22 mm door thickness: the feature that sets us apart. Our Sistema 22.2 offers various possibilities for customisation of doors and fronts, paying particular attention to ergonomics and design.

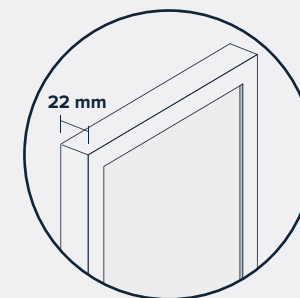

OPENING METHODS



FRONTS	PUSH PULL	CONCAVE GRIP-GROOVE	HANDLE
TELAIA SPAZIO	●	●	●

TELAIA SPAZIO



/

S22 FRONTS

ALU-BOX

The 22 mm door thickness: the feature that sets us apart. Our Sistema 22.2 offers various possibilities for customisation of doors and fronts, paying particular attention to ergonomics and design.

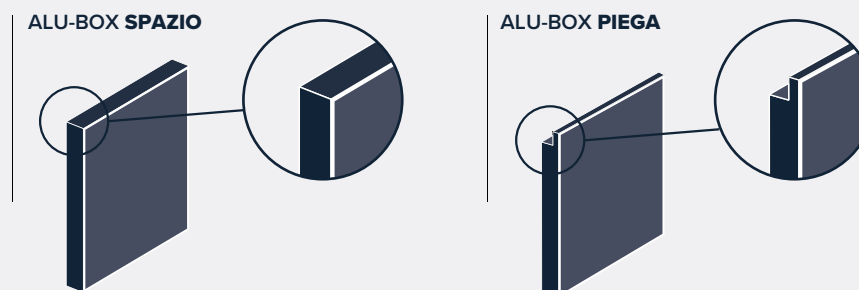
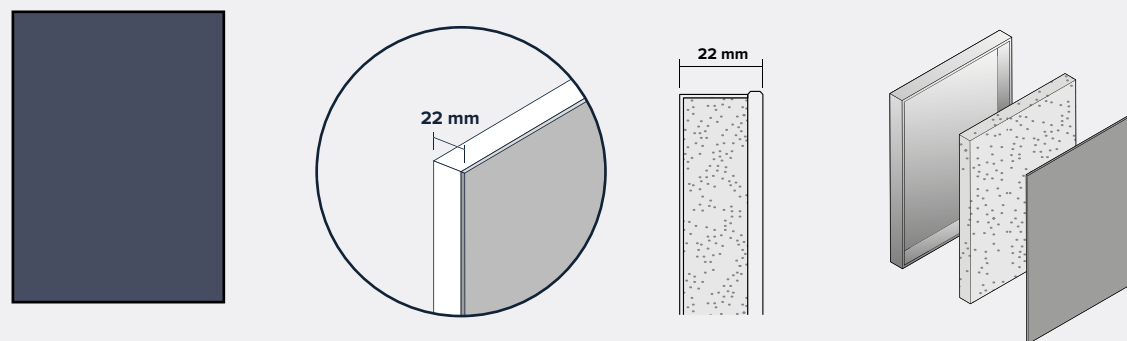

OPENING METHODS



FRONTS

	PUSH PULL	FLAT GRIP GROOVE	CONCAVE GRIP-GROOVE
ALU-BOX SPAZIO	●		●
ALU-BOX PIEGA		●	●

/ S22 FRONTS ALLUMINIA

The 22 mm door thickness: the feature that sets us apart. Our Sistema 22.2 offers various possibilities for customisation of doors and fronts, paying particular attention to ergonomics and design.

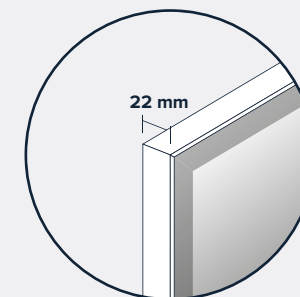
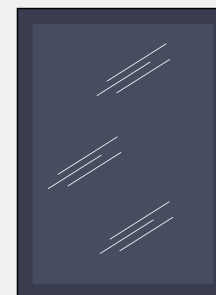

OPENING METHODS



PUSH PULL



CONCAVE
GRIP-GROOVE



HANDLE

FRONTS

ALLUMINIA SPAZIO



ALLUMINIA SPAZIO





VIA GEMONA, 22/24
ZONA INDUSTRIALE PONTEROSSO EST

SAN VITO AL TAGLIAMENTO (PN)
33078 - ITALY

info@altacucine.com
+39 0434 844 311

www.altacucine.com